

.100	Socket	Double Row - .025 SMS Extender	Straight	Thru Hole
------	--------	--------------------------------	----------	-----------

.100 inch Center - Extender - Double Row Straight - accepting .025 inch Square Pin - Screw Machine Socket

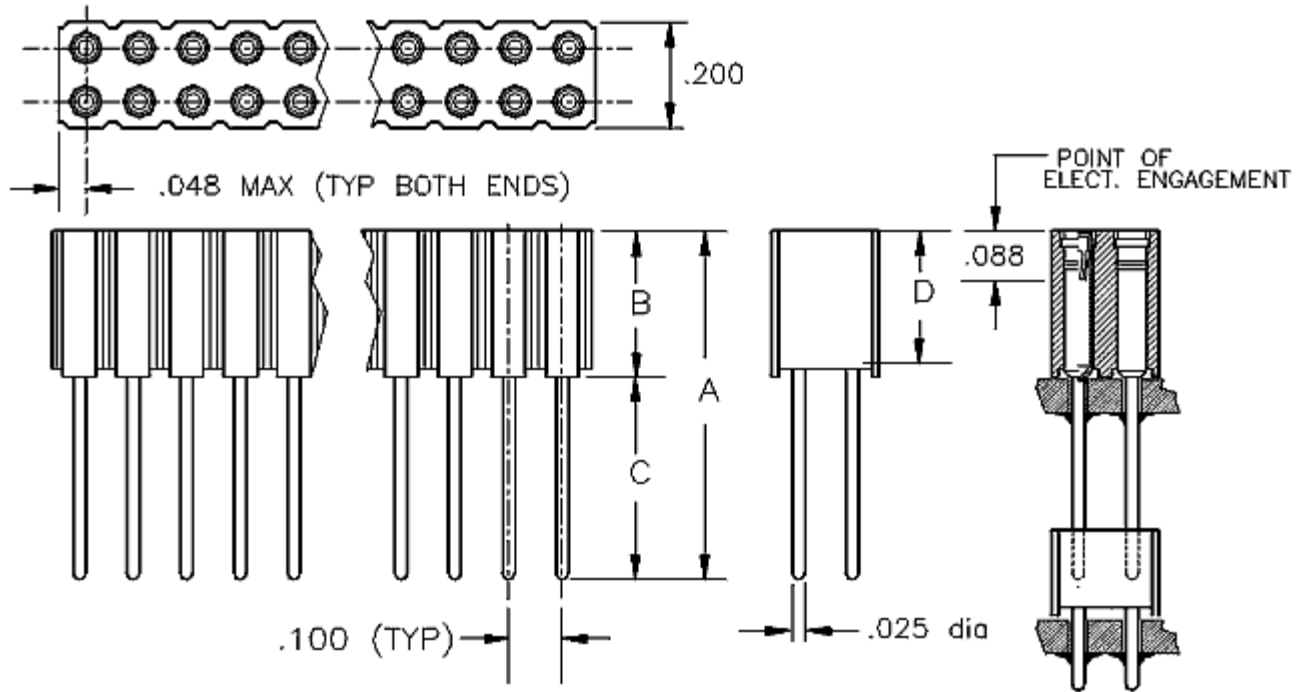

Base Part Number	A		B		C		D		E		Plating Options	Number of Positions
	mm	Inch	mm	Inch	mm	Inch	mm	Inch	mm	Inch		
1179	13.34	0.525	10.92	0.430	2.29	0.090	5.79	0.228			G2	4-80
1172	18.29	0.720	6.86	0.270	11.43	0.450	5.79	0.228			G1 : G2	4-80
1178	18.29	0.720	16.00	0.630	2.29	0.090	5.79	0.228			G1 : G2	4-80
1180	18.29	0.720	13.46	0.530	4.83	0.190	5.79	0.228			G1 : G2	4-80
1174	18.29	0.720	10.92	0.430	7.37	0.290	5.79	0.228			G1 : G2	4-80
1183	23.37	0.920	18.54	0.730	4.83	0.190	5.79	0.228			G1 : G2	4-80
1175	23.37	0.920	10.92	0.430	12.45	0.490	5.79	0.228			G	4-80
1173	23.37	0.920	6.86	0.270	16.51	0.650	5.79	0.228			G1 : G2	4-80
1177	23.37	0.920	16.00	0.630	7.37	0.290	5.79	0.228			G1 : G2	4-80
1182	23.37	0.920	13.46	0.530	9.91	0.390	5.79	0.228			G1 : G2	4-80

Technical Notes	
Contact Material:	Shell: Phosphor Bronz - Contact Clip: 6 finger BeCu [#47]
Insulation Material:	Glass Filled Nylon 46 - UL 94V-0 rated - Black (std)
Heat Deflection:	260°C @ 264 PSI per ASTM D648
Insulation Resistance:	5000 MegOhm @ 500VDC

Current Rating:	3 amp continuous @ 100 VDC/contact
Max Processing Temp:	250°C for 60 seconds
Insertion Force:	typ initial per: 194 grams(6.8oz) w/.025 inch rd pin & 230 grams(8.1oz) w/.025sq pin
Extraction Force:	typ initial per: 122 grams(4.3oz) w/.025 inch rd pin & 92 grams(3.2oz) w/.025sq pin
Plastic:	High Temperature Compatible

COMM CON CONNECTORS INC.

1848 Evergreen Street, Duarte, Ca 91010 · (626) 301-4200 · fax (626) 301-4212 · e-mail:
info@commcon.com